

Austin Standing Seam Awning Assembly and Installation Instructions

Be sure to use safety glasses when assembling and installing the awning. Some metal parts may have sharp edges. Use work gloves to handle them.

These instructions are available online at <https://www.generalawnings.com/instructions>.

Assembly Instructions

STEP 1. Arrange the awning frame parts as shown below. All the rivet nuts (threaded inserts) in the awning rafters should face up and be on your side of the awning frame, as shown.

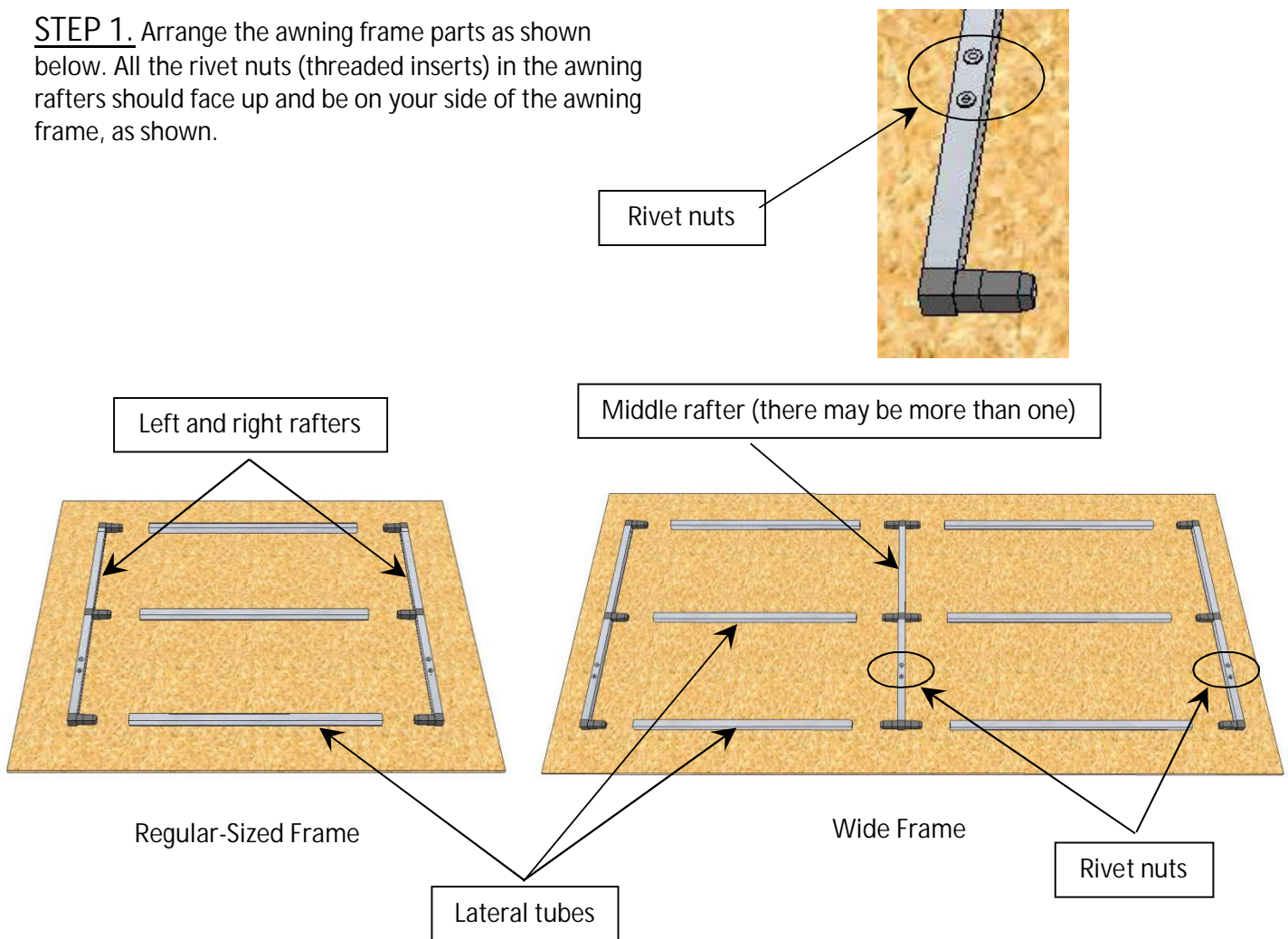

STEP 2. Assemble the awning frame: Using a mallet, assemble the rafters with lateral tubes.

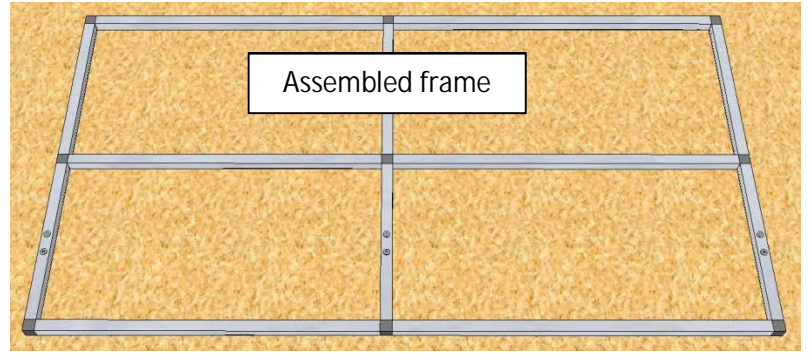

STEP 3. Turn the frame, so that the rivet nuts (threaded inserts) face down. They will be used later to attach support arms. If you ordered an optional gutter, perform STEP 3A on the right.

STEP 3A. Gutter installation. Position the gutter on top of the front lateral tube. Align the back edge of the gutter with the back edge of the front tube. It is advisable to clamp the gutter to the front tube.

Install the left flashing. If you have a gutter, the flashing installs on top of the gutter. The flashing should overhang the frame by 1-1/4". Secure the flashing to all the intersecting lateral tubes with self-drilling screws as shown below.

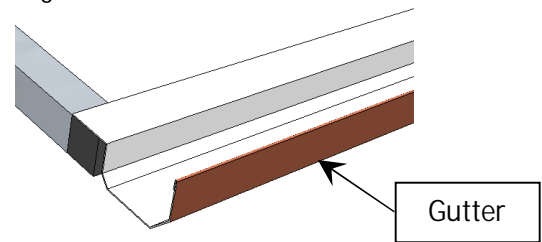

If your gutter consists of multiple sections, seal the gutter joints with the included FLEX TAPE®.

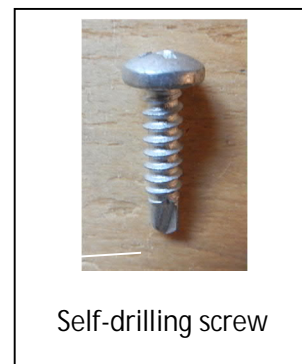
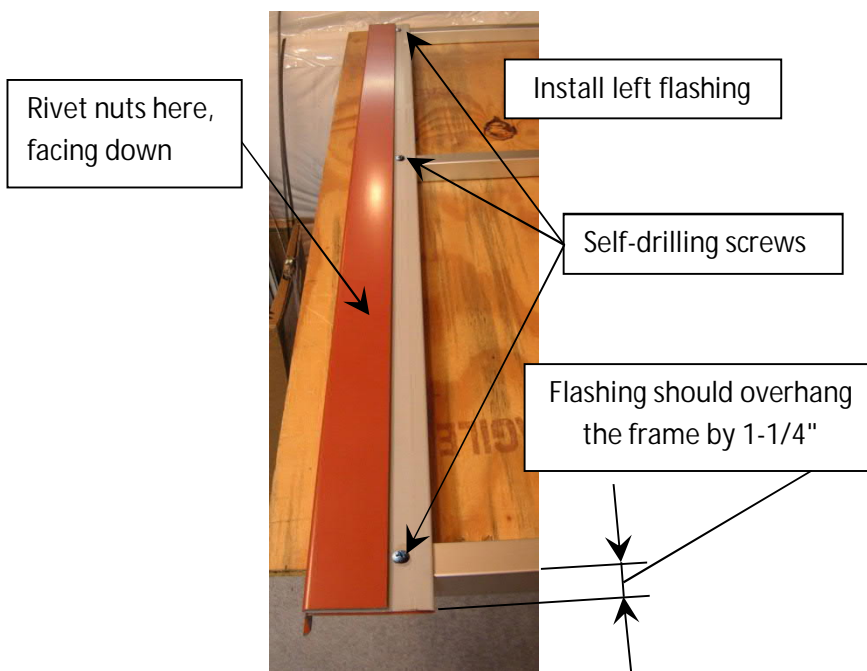

STEP 4. Install the right flashing. It should overhang the frame by the same 1-1/4". Secure the right flashing to all the intersecting lateral tubes with self-drilling screws.

Optional for large awnings: See "Large Awning Assembly and Installation" on the last page.

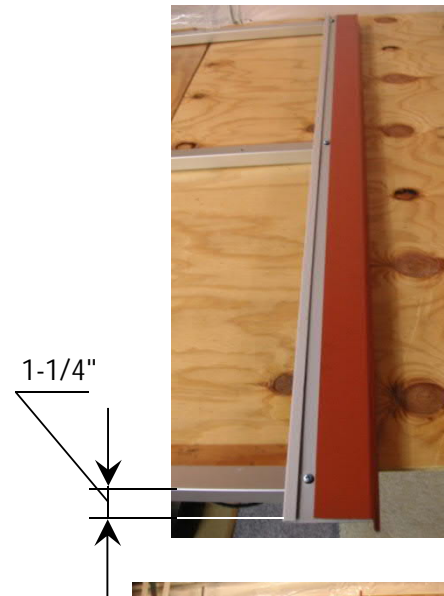

STEP 5. Insert the left-end panel all the way into the left flashing as shown.

Make a mark at the right edge of the left-end panel.

Remove the left-end panel and make another mark 1/4" to the right of the first mark.

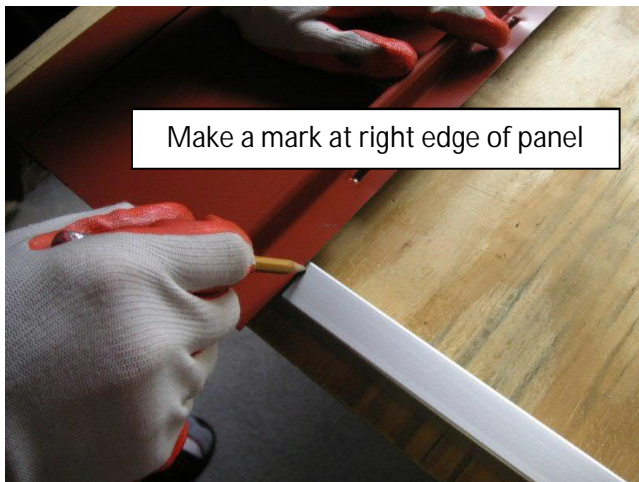

Measure the distance from the right edge of the frame to the last mark. In this example, it's 55-1/8".

On the back lateral tube (opposite side of the frame), make a mark at the same distance from the right edge of the frame.

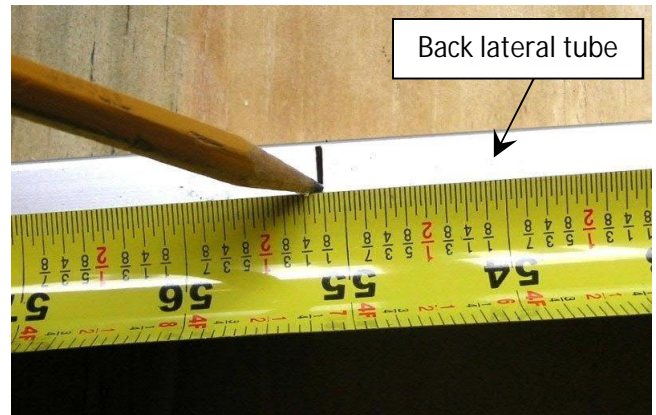
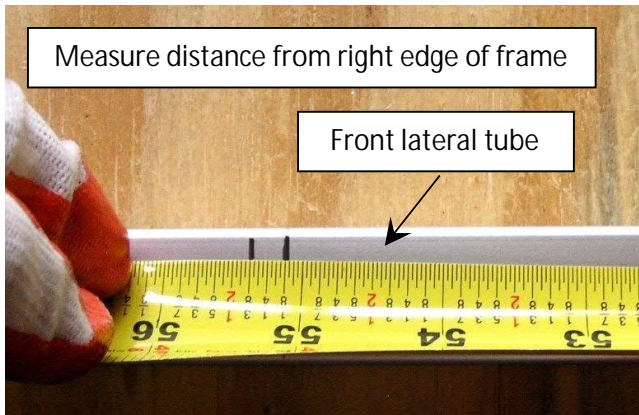

STEP 6. Re-insert the left-end panel into the left flashing and align its right edge with the last two marks on the front and back lateral tubes. Align the front edge of the panel with the left flashing.

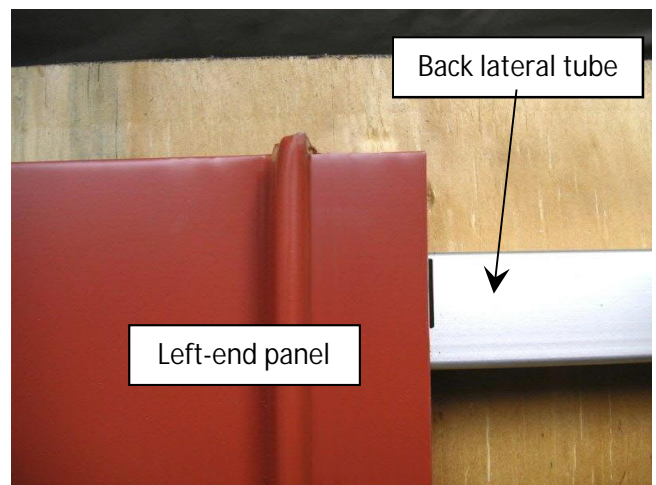
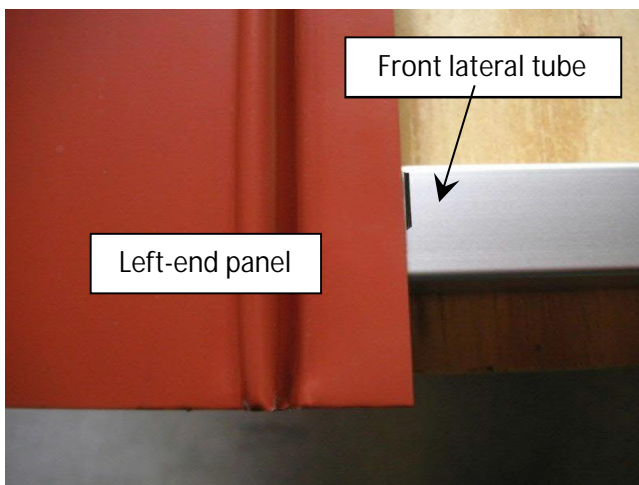

Clamping the left-end panel to the frame will help prevent its movement during attachment. Absent clamps, you may want to drill a pilot hole before driving the self-drilling screws.

Secure the panel to all intersecting lateral tubes with self-drilling screws.



STEP 7. Attach a full panel to the left-end panel by placing its female rib over the male rib of the left-end panel and pressing it down until the ribs lock together.

Use a ruler or a wood plank with a straight edge to make sure that the panel aligns with both left and right flashings.

Use a mallet to align the panel edge if necessary.

Secure the full panel to all intersecting lateral tubes with self-drilling screws.

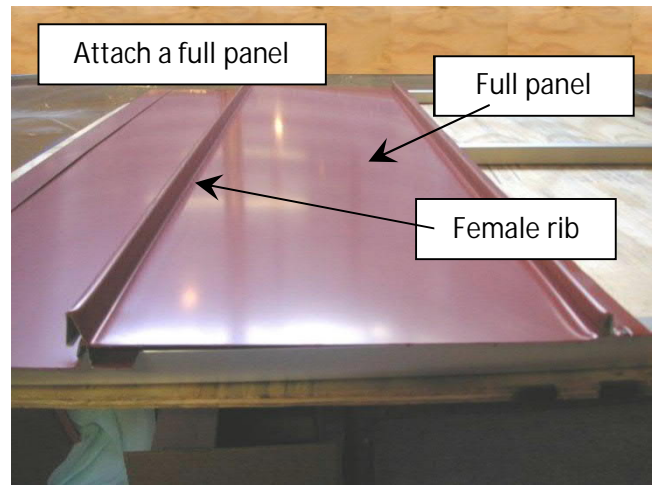

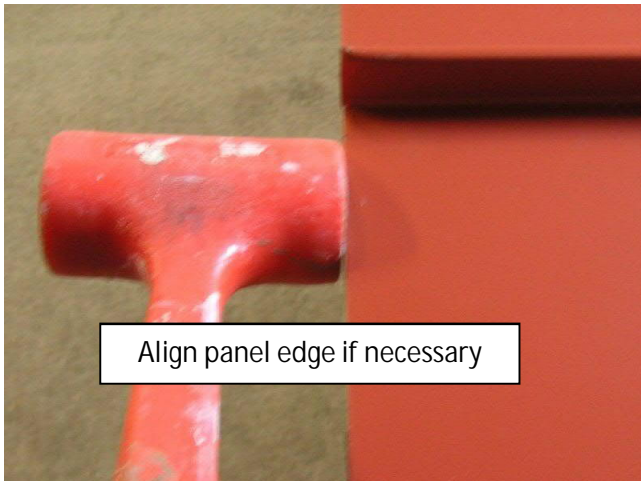
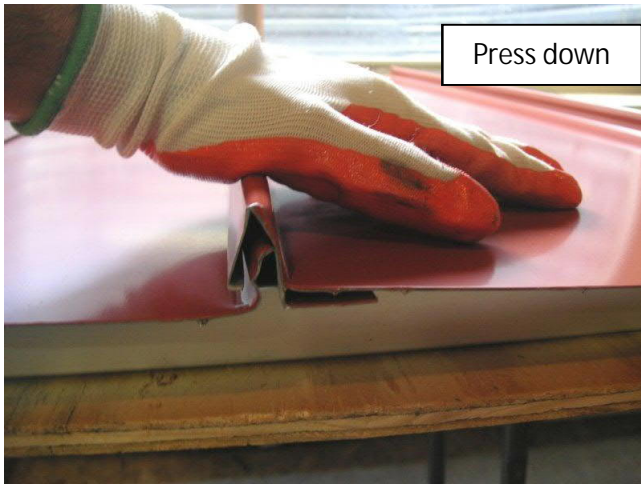

STEP 8. Install and secure with self-drilling screws all remaining full panels while making sure that they align with both left and right flashings.

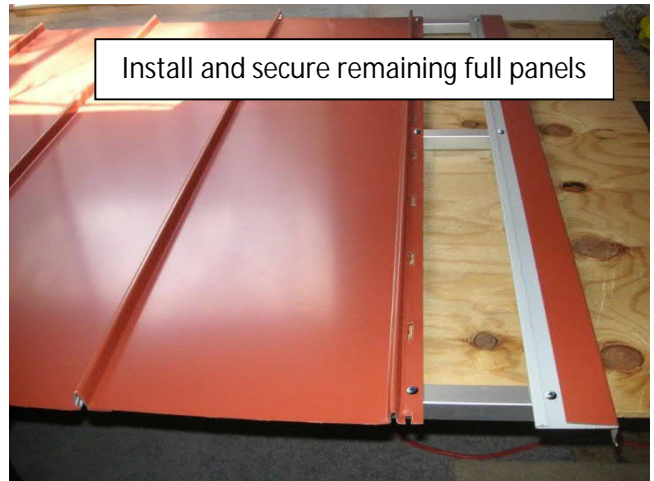

STEP 9. Insert the right-end panel into the right flashing and lock it onto the adjacent full panel.

Insert and lock right-end panel

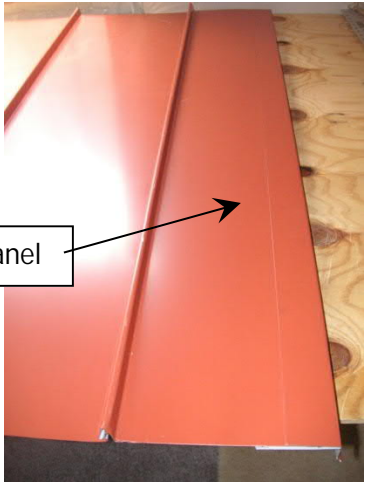

STEP 10. Turn the assembly upside down and attach support arm brackets with 1/4"-20 x 7/8" machine screws.

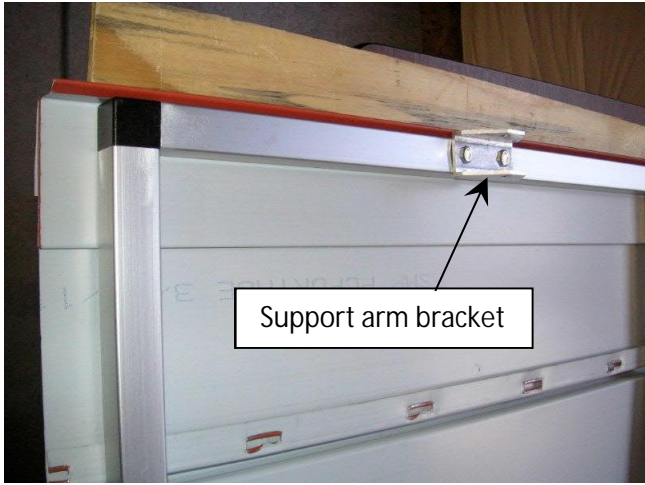
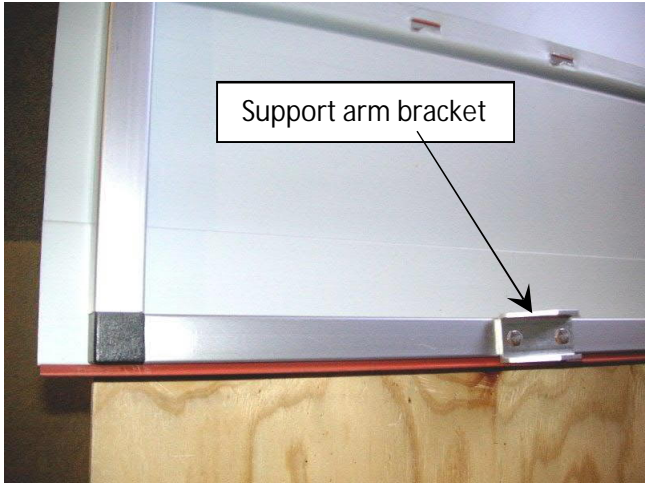

STEP 11. Attach support arms (with brackets pre-attached to the other end) using 1/4"-20 x 1-3/4" bolts with nuts and split lock washers. Do not tighten the nuts completely.



1/4"-20 x 1-3/4" Bolt with Nut and Lock Washer

Pre-attached support arm bracket

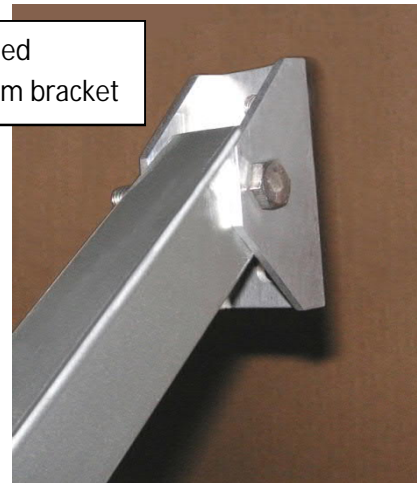

Support arm

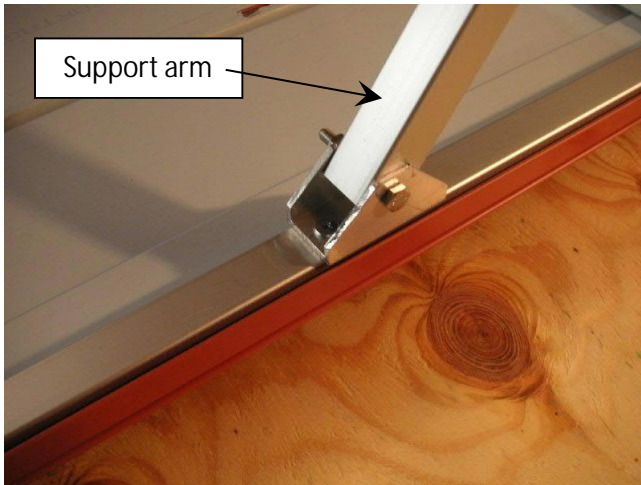

Support arm

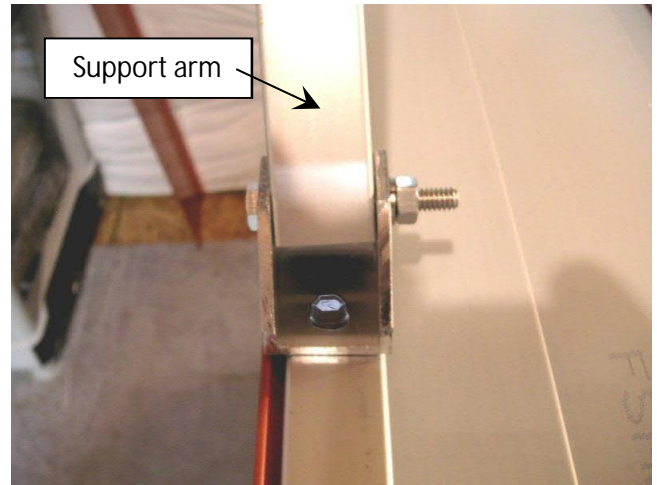

Assembly completed.

Support arm



Installation Instructions

STEP 1. Mark locations for the canopy wall brackets, drill appropriate pilot holes and install the canopy wall brackets using 1/4" x 3-1/2" lag screws or other fasteners appropriate for your siding and wall construction. Make sure that the fasteners are properly engaged with structural framing, such as wall studs. If you are not certain about the use of fasteners, consult with or hire a qualified professional. Use only the lower fastener at this point. Do not tighten completely.

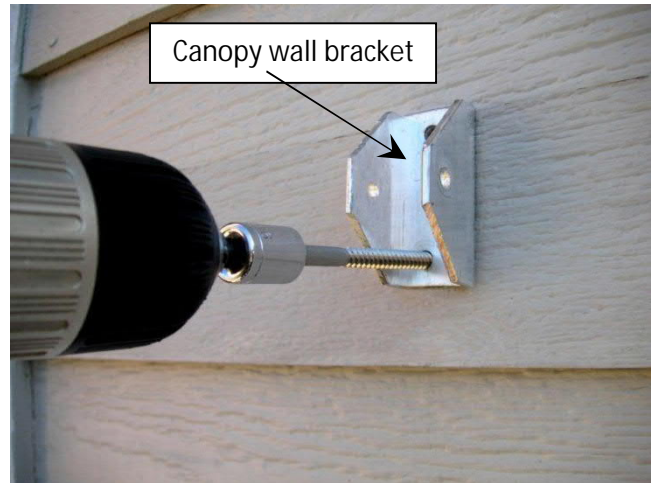

Note: Your awning may come with alternative canopy wall brackets shown below.

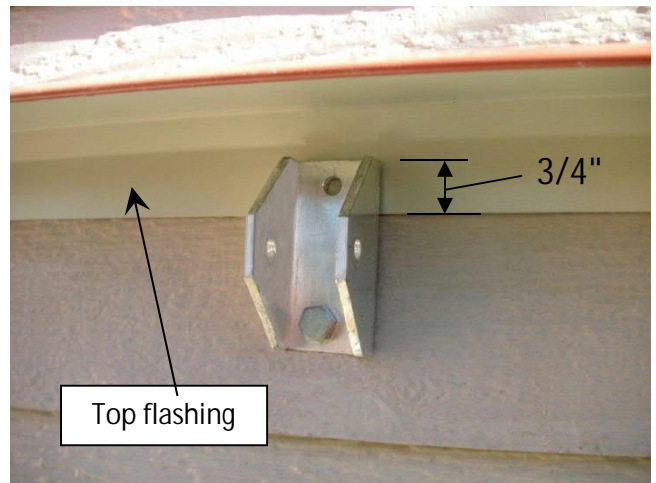

STEP 2. Insert the top flashing behind the canopy wall brackets and lower it by approximately 3/4" below the top of the brackets.

Level the top flashing and secure the canopy wall brackets and the top flashing with a second fastener as shown. Again, make sure that you use fasteners appropriate for your siding and wall construction and that the fasteners are properly engaged with structural framing, such as wall studs. Tighten all canopy wall bracket fasteners.

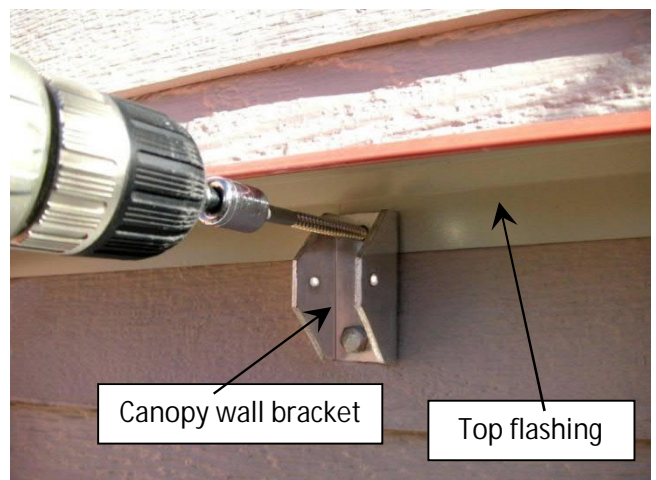

STEP 3. Seal the top flashing against the wall with an appropriate sealant, such as an exterior grade silicone caulk.



STEP 4. Attach headrod brackets to canopy wall brackets using 1/4"-20 x 1-3/4" bolts with nuts and lock washers. Do not tighten the nuts completely.

Bolt with nut and lock washer

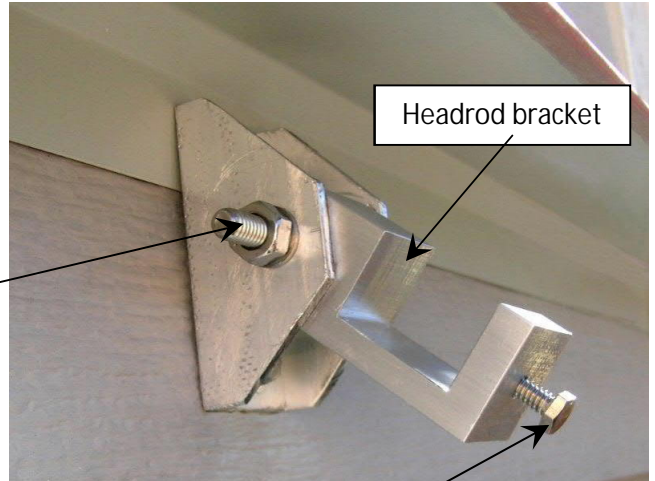

STEP 5. Mount the awning by inserting the headrod (back lateral tube) into the headrod bracket slots.

Tighten the headrod bracket screws tightly, to make sure the headrod is firmly secured in the headrod brackets.

Headrod bracket screw

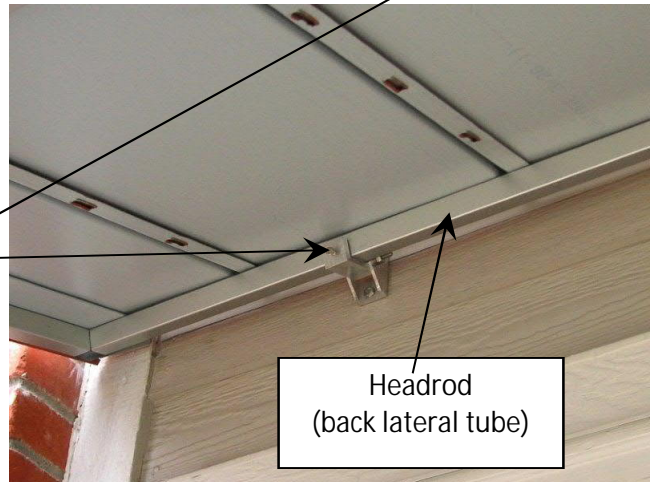

STEP 6. Position the lower support arm brackets on the wall, so that the awning is level and slopes at your desired angle. Mark the locations of the lower bracket holes.



STEP 7. Detach lower support arm brackets from the support arms. Secure the brackets to the wall using the marks made in the previous step. Use 1/4" x 2" lag screws or other fasteners appropriate for your siding and wall construction.



1/4" x 2" Lag Screw

STEP 8. Re-attach the support arms to the wall brackets. Tighten all the support arm bracket nuts at the wall and at the canopy.



STEP 9. Tighten the headrod bracket nuts.

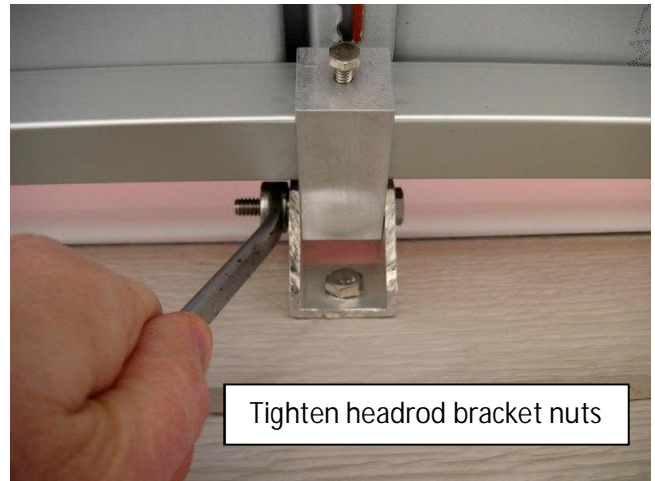

Installation completed.



Large Awning Assembly and Installation

To assemble and install a large and heavy awning, it may be advisable to install the roof panels after the awning frame is mounted on the wall, using the following procedure:

- Assemble the awning frame, attach left and right flashings, left end panel, support arm brackets and support arms (assembly steps 1-6, 10, 11).
- Mount the frame on the wall (installation steps 1-7).
- Bring the frame into a convenient position for the installation of roof panels, use a temporary support structure if necessary to support the frame.
- Install the roof panels (assembly steps 7, 8, 9).
- Lift the frame and attach the support arms to the brackets on the wall, tighten all nuts (installation steps 8-9).